

VETONIITTI AL/ST, UPPOKANTA AVOIN

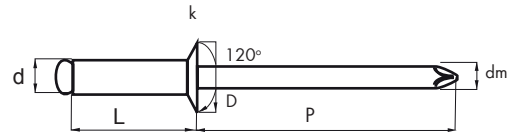
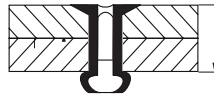

Niitti: Al 3,5% (5154)
Vetokara: St

Tuotenumero	d (mm)	L (mm)	S (mm)	Pora Ø (mm)	D (mm)	k (mm)	P Min (mm)	dm (mm)	Leikkauslujuus N	Veto-lujuus N	Käyttöympäristö
0938 32 6	3,2	6,0	1,5-3,5	3,3	6,0 [+0/-0,4]	0,9	27	1,79	670	900	C2
0938 32 8	3,2	8,0	3,5-5,5								
0938 32 10	3,2	10,0	5,5-7,0								
0938 32 12	3,2	12,0	7,0-9,0								
0938 4 8	4,0	8,0	3,0-5,0	4,1	7,5 [+0/-0,5]	1,0	27	2,18	1050	1560	
0938 4 10	4,0	10,0	5,0-6,5								
0938 4 12	4,0	12,0	6,5-8,5								
0938 4 16	4,0	16,0	10,5-12,5								
0938 4 18	4,0	18,0	12,5-14,5	4,9	9,0 [+0/-0,5]	1,2	27	2,70	1700	2230	
0938 4 88	4,8	8,0	2,5-4,5								
0938 48 10	4,8	10,0	4,5-6,0								
0938 48 16	4,8	16,0	10,0-12,0								

VETONIITTI AL/ST, LAAJAKANTA AVOIN

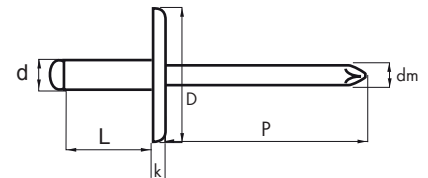
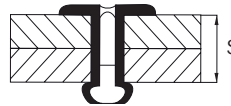
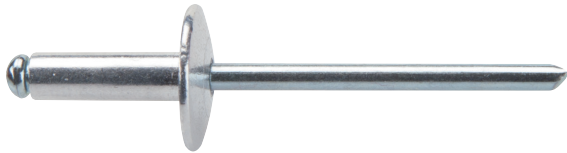

Niitti: Al 3,5% (5154)
Vetokara: St

Tuotenumero	d (mm)	L (mm)	S (mm)	Pora Ø (mm)	D (mm)	k (mm)	P Min (mm)	dm (mm)	Leikkauslujuus N	Veto-lujuus N	Käyttöympäristö
0944 103 28	3,2	8,0	3,5-5,0	3,3	9,5 [+0,3/-0,7]	2,0	27	1,78	670	900	C2
0944 103 212	3,2	12,0	7,0-9,0								
0944 104 10	4,0	10,0	5,0-6,5	4,1	12,0 [+0,5/-1,0]	2,5	27	2,18	1050	1560	
0944 104 12	4,0	12,0	6,5-8,5								
0944 104 14	4,0	14,0	8,5-10,5								
0944 104 16	4,0	16,0	10,5-12,5								
0944 148 9	4,8	8,0	3,0-4,5	4,9	14,0 [+0,5/-1,0]	2,5	27	2,70	1700	2230	
0944 104 812	4,8	12,0	6,0-8,0								
0944 104 814	4,8	14,0	8,0-10,0								
0944 104 816	4,8	16,0	10,0-12,0								
0944 104 818	4,8	18,0	12,0-14,0								
0944 104 820	4,8	20,0	14,0-16,0								
0944 482 5	4,8	25,0	16,0-21,0								
0944 104 825	4,8	25,0	16,0-21,0								
0944 104 830	4,8	30,0	21,0-26,0								
Mustakanta											
0944 412 100	4,0	10	5-7	5	12				1180	1600	
0944 914 16	4,8	16	8,5-12	5	14				2110	2940	